

Model RM-30A1 Reeling Machine-Launcher

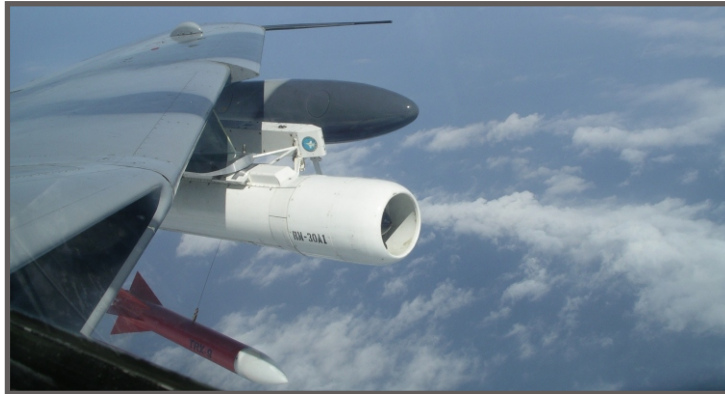

Features

- Two-way reeling system, permitting recovery and reuse of tow targets
- In use with Gulfstream G-100, Learjet 35 & 36, Falcon 20, Alpha jet, L-59 and Hawker Hunter aircraft
- Microprocessor Logic Control Module (MLCM) provides dependable “user defined” system control and features automatic, power-up self-test of the RM-30A1
- Redundant towline cutters
- Compatible with NATO standard ejector rack lug spacing
- Available with left, right or centerline mounted saddle launcher enabling easy configuration to meet differing aircraft needs with respect to ground clearance and aircraft features
- Optional video kit available to monitor target recovery
- Qualified for worldwide use IAW US Military Specifications and Standards

Description

The RM-30A1 represents the state-of-the-art in high performance reeling machine equipment. The primary feature of this upgrade to Meggitt's original RM-30A series of machines is the complete elimination of all pneumatic and hydraulic systems. The RM-30A1 operates exclusively on electric power and remains compatible with all aircraft on which the original RM-30A systems have been qualified. This revised machine is even simpler to maintain than its predecessor and retains all of the original machine's automatic reeling functions, enabling the tow aircraft pilot to operate this machine with minimal interference to his normal cockpit workload. The RM-30A control panel is retained for the RM-30A1, providing a selectable, digital display of towline length and tension.

The RM-30A1 has an advanced ram-air turbine power unit that produces 30 percent more horsepower than the RM-30A. This enables average reeling speeds of up to 2,000 FPM. The spool can hold up to 9,754 meters (32,000 ft) of towline depending on the target configuration being towed, mission safety requirements, and towline size. The RM-30A1, RM-30A, and its derivative, the RMK-35 (AGTS-36), are currently in use by many of the military forces of the world, including the United States, Japan, Korea and England. These machines are readily adaptable and certifiable with other tow aircraft.

Model RM-30A1 Reeling Machine-Launcher

Specifications

PERFORMANCE

Reeling

- Tow Aircraft Speed (MAX) 250 KCAS
- Average Towline Speed
(User Defined) Typically 2600 FPM
- Final Recovery Speed
(User Defined) Typically 180 FPM

Towing

- Tow Aircraft Speed (MAX) 600 KCAS

TYPICAL TOWLINE LOAD

- Recovery (250 KCAS) 1355 LB
- Towing 4000 LB
- Maximum Load Rating 6000 LB

ELECTRICAL

- Operating Voltage 28 DC
- Current (MAX Reeling) 10 AMP

MECHANICAL

Suspension Lugs

- 14.0 Spacing MS3314
- 30.0 Spacing MK 3 MOD 0

- Spool Volume (MAX) 2500 IN³
- Towline Length (0.082 Dia) 26000 FT

EXTERNAL LAUNCHER

- Height 6.5 IN
- Length 55.5 IN
- Width 5.0 IN
- Weight 54.0 LB
- Cutter Cartridge MK 23 MOD 0

COCKPIT CONTROL PANEL

- Height 2.63 IN
- Length 6.00 IN
- Width 5.75 IN
- Weight 2.1 LB
- Operating Voltage 28 DC
- Current 1 AMP
- Weight (Less Towline & Launcher) 440 LB

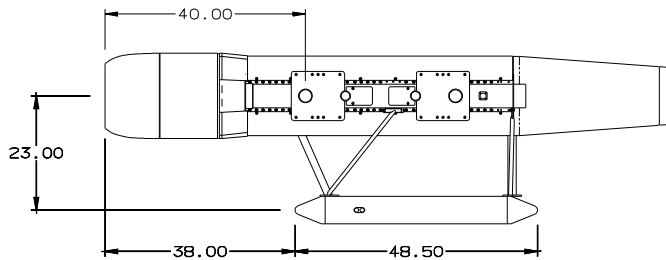

Meggitt Defense Systems, Inc.
9801 Muirlands Blvd.
Irvine
California
92618
United States

Tel: 949 465 7700
Fax: 949 465 9560

www.meggittdefense.com

MEGGITT
smart engineering for
extreme environments